

XRAY T3R

INSTRUCTION MANUAL SUPPLEMENTARY SHEET

The T3R Raycer is based on the hugely-successful, race-winning T3 and as such the majority of spare parts and option parts are fully compatible between the two cars. The T3R kit includes the Instruction Manual for the T3 along with this Supplementary Instruction Sheet.

New and Improved Parts

All of these parts are new or updated from the previous versions. Each of these parts feature their corresponding part number which can be used to re-order the parts. You can also refer to the complete exploded views. Please note that some parts - such as fiberglass parts - are not available separately as a spare part; in the event that a replacement is needed for any of those parts, then only the optional parts or equivalent parts from the T3 are available.



#301129
T3 CHASSIS 2.5MM GRAPHITE - RUBBER-SPEC (OPTION)



#301190
T3 RUBBER-SPEC UPPER DECK 2.0MM GRAPHITE (OPTION)



#301203
IMPACT ABSORBING FRONT BUMPER



#302047-0
T3 ALU LOWER FRONT SUSPENSION
1-PIECE HOLDER - ORANGE (OPTION)



#302048 -0
T3 ALU LOWER REAR SUSPENSION
1-PIECE HOLDER - ORANGE (OPTION)



#302087
SHOCK TOWER FRONT 3.0MM GRAPHITE - V2 (OPTION)



#302253
COMPOSITE STEERING BLOCK - HARD



#302345
COMPOSITE C-HUB FRONT BLOCK, RIGHT - 4° DEG.



#302346
COMPOSITE C-HUB FRONT BLOCK, LEFT - 4° DEG.



#302610
ADJ. TURNBUCKLE M3 L/R - SPRING STEEL (2) (OPTION)



#303032
ALU QUICK ROLL-CENTER HOLDER™ 4.9MM (2)



#303089
T3 SHOCK TOWER REAR 3.0MM GRAPHITE (OPTION)



#303353
COMPOSITE UPRIGHT 1°
OUTBOARD TOE-IN - RIGHT - HARD



#303363
COMPOSITE UPRIGHT 1°
OUTBOARD TOE-IN - LEFT - HARD



#305006 T2R PRO COMPOSITE BALL DIFFERENTIAL - SET
#305058 DIFF PULLEY 38T WITH LABYRINTH DUST COVERS



#305326
ALU DRIVE SHAFT SWISS 7075 T6 - HARD COATED - 52MM



#305340
DRIVE AXLE - HUDY SPRING STEEL



#305355
T2 COMPOSITE WHEEL HUB (2)



#309319
COMPOSITE UNIVERSAL SET OF SHIMS



#308382 SPRING-SET D=1.4 (14 LB) GOLD (4)
#308383 SPRING-SET D=1.5 (17.5 LB) SILVER (4)



#901320 HEX SCREW SB M3x20 (10)
#901325 HEX SCREW SB M3x25 (10)

FRONT SOLID AXLE

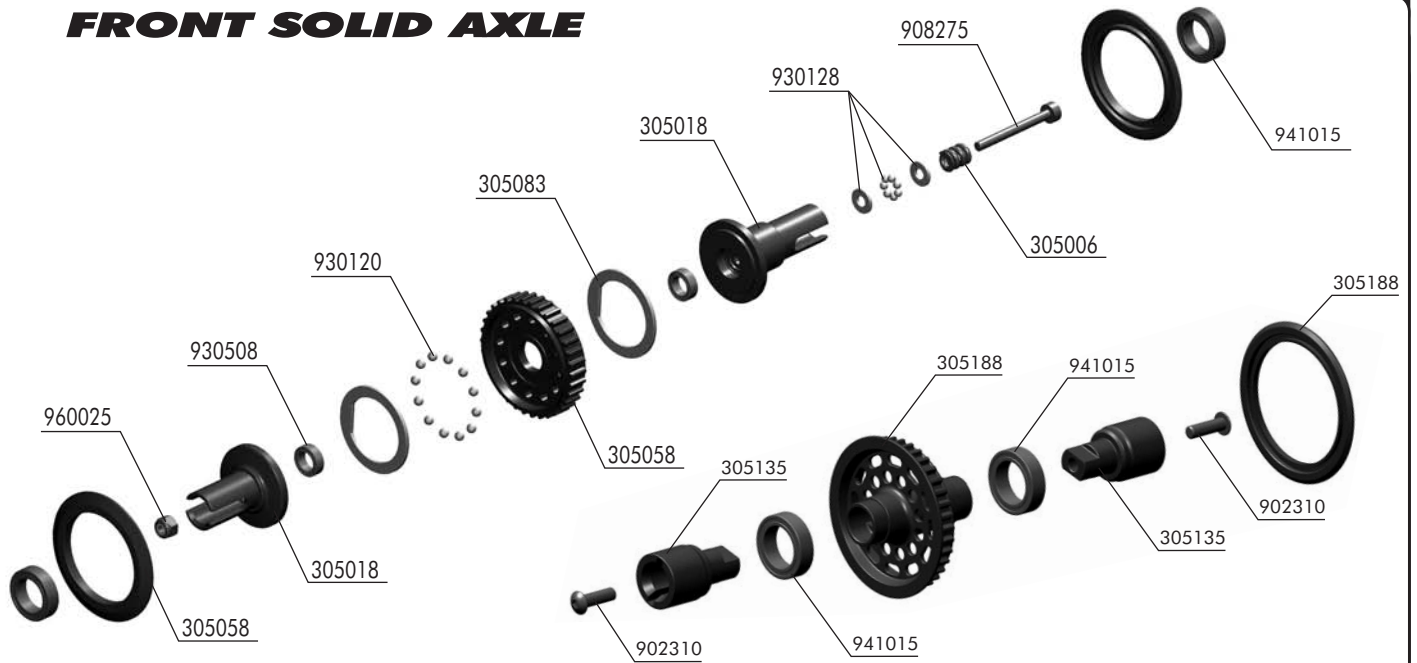

BAG

01.1

01.2

30 5003 ALU BALL DIFFERENTIAL 34T+38T PULLEY - SET (OPTION)
 30 5006 T2R PRO COMPOSITE BALL DIFFERENTIAL - SET
 30 5018 T2R PRO COMPOSITE DIFF OUTPUT SHAFTS (2)
 30 5083 D-LOCK DIFF WASHER - D 17 x 23 x 1 (2)
 30 5058 DIFF PULLEY 38T WITH LABYRINTH DUST COVERS
 30 5104 XRAY MULTI-DIFF™ (OPTION)
 30 5135 COMPOSITE SOLID AXLE DRIVESHAFT ADAPTERS (2)
 30 5136 ALU SOLID AXLE DRIVESHAFT ADAPTERS (2) (OPTION)
 30 5188 COMPOSITE SOLID AXLE 38T - SET

90 2310 HEX SCREW SH M3x10 (10)
 90 8275 HEX SCREW SOCKET HEAD CAP M2.5x25 (10)
 93 0120 CARBIDE BALL 2.4 MM (12)
 93 0128 CARBIDE BALL-BEARING AXIAL 2.8x6.5x0.8
 93 0508 BALL-BEARING MR85ZZ 5x8x2.5 (2)
 94 1015 HIGH-SPEED BALL-BEARING 10x15x4 RUBBER SEALED (2)
 96 0025 NUT M2.5 (10)



930508
BB 5x8x2.5



930120
B 2.4



960025
N 2.5



908275
SCH M2.5x25



930128
BA 2.8x6.5

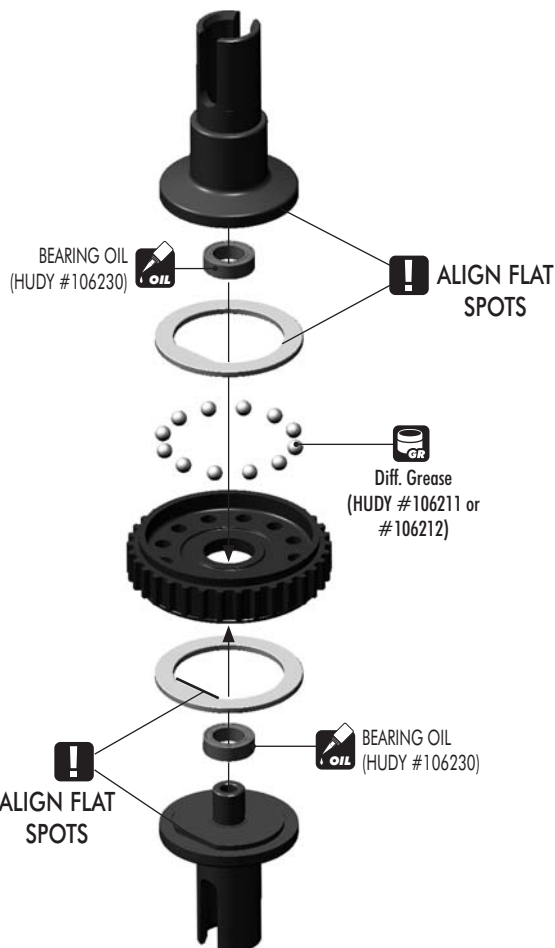

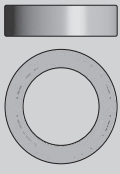

941015
BB 10x1.5x4

IMPORTANT: When you build the differential, do not tighten it fully initially; the differential needs to be broken in properly. When you build the diff tighten it very gently. When you put the diff in the car and complete the assembly, run the car for a few minutes, tighten the diff a little bit, and then recheck the diff. Repeat this process several times until you have the diff tightened to the point you want it. Final adjustments should ALWAYS be made with the diff in the car and on the track.

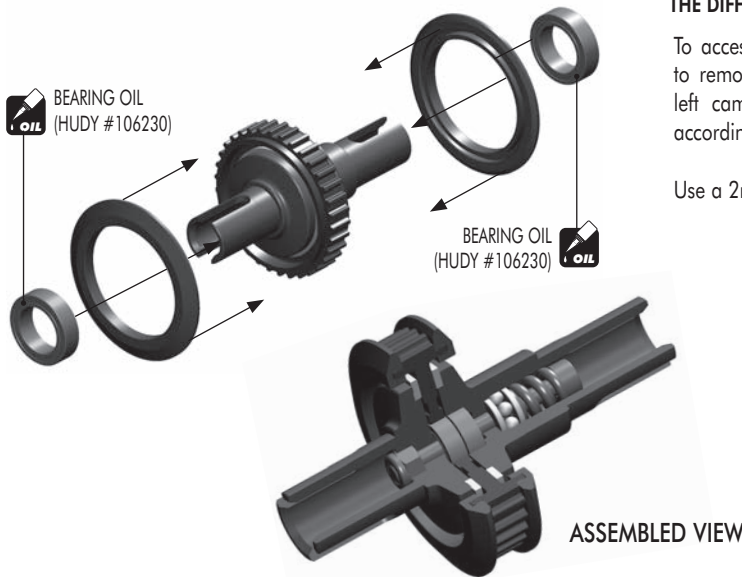

**DO NOT TIGHTEN THE DIFF COMPLETELY
THE DIFF MUST BE BROKEN IN PROPERLY!**

To access the diff when it is installed in the car, you need to remove the front right camber linkage and/or the rear left camber linkage to detach the front/rear suspension accordingly.

Use a 2mm hex wrench to adjust the diff.

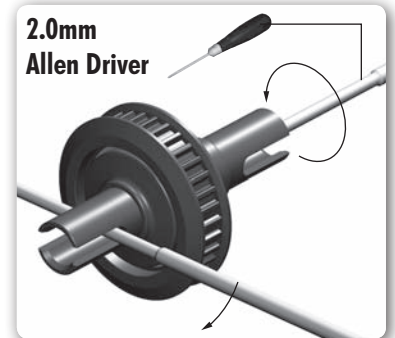

COMPOSITE FRONT SOLID AXLE

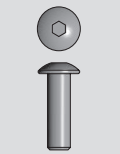

902310
SH M3x10

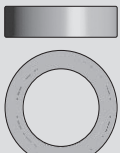

941015
BB 10x1.5x4

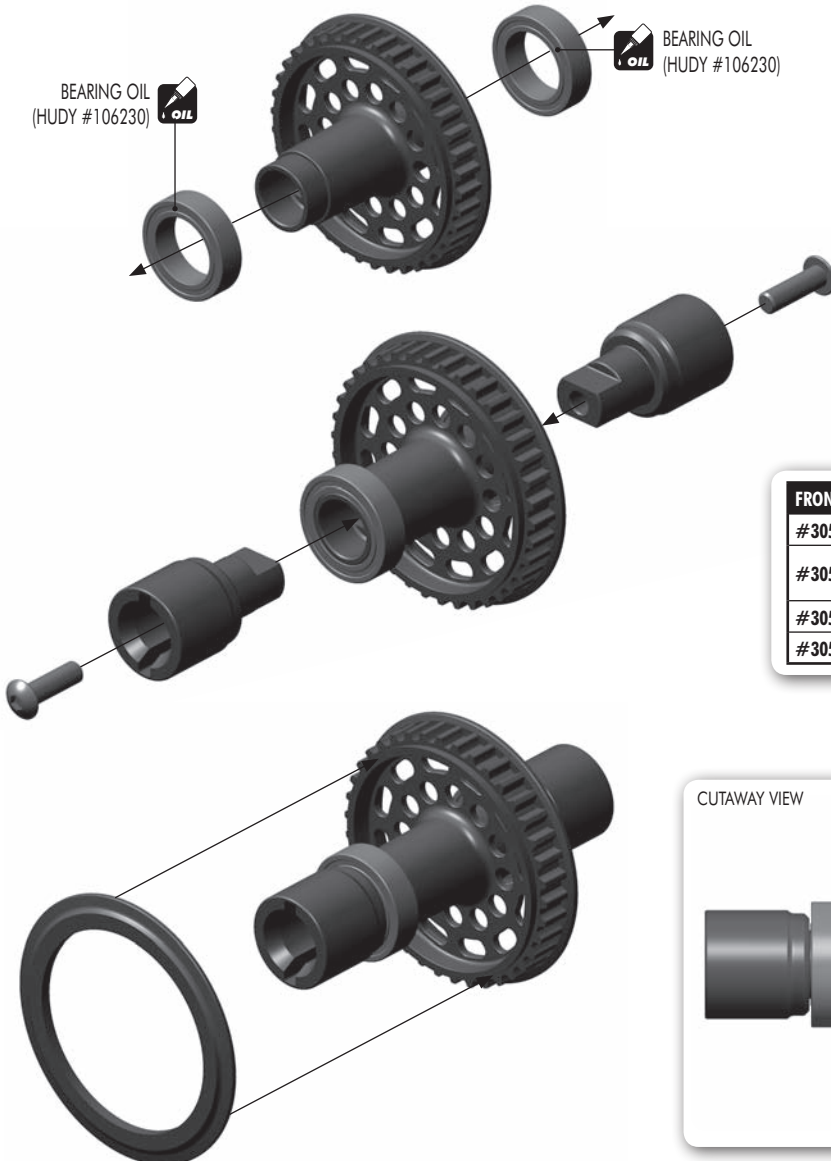

FRONT & REAR AXLES	
#305003	ALU DIFF 34T + 38T PULLEY
#305006	COMPOSITE DIFF + #305058 DIFF PULLEY 38T
#305104	XRAY ALU MULTI-DIFF
#305188	COMPOSITE SOLID AXLE 38T PULLEY

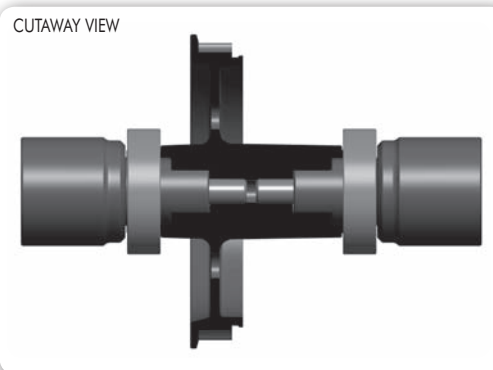

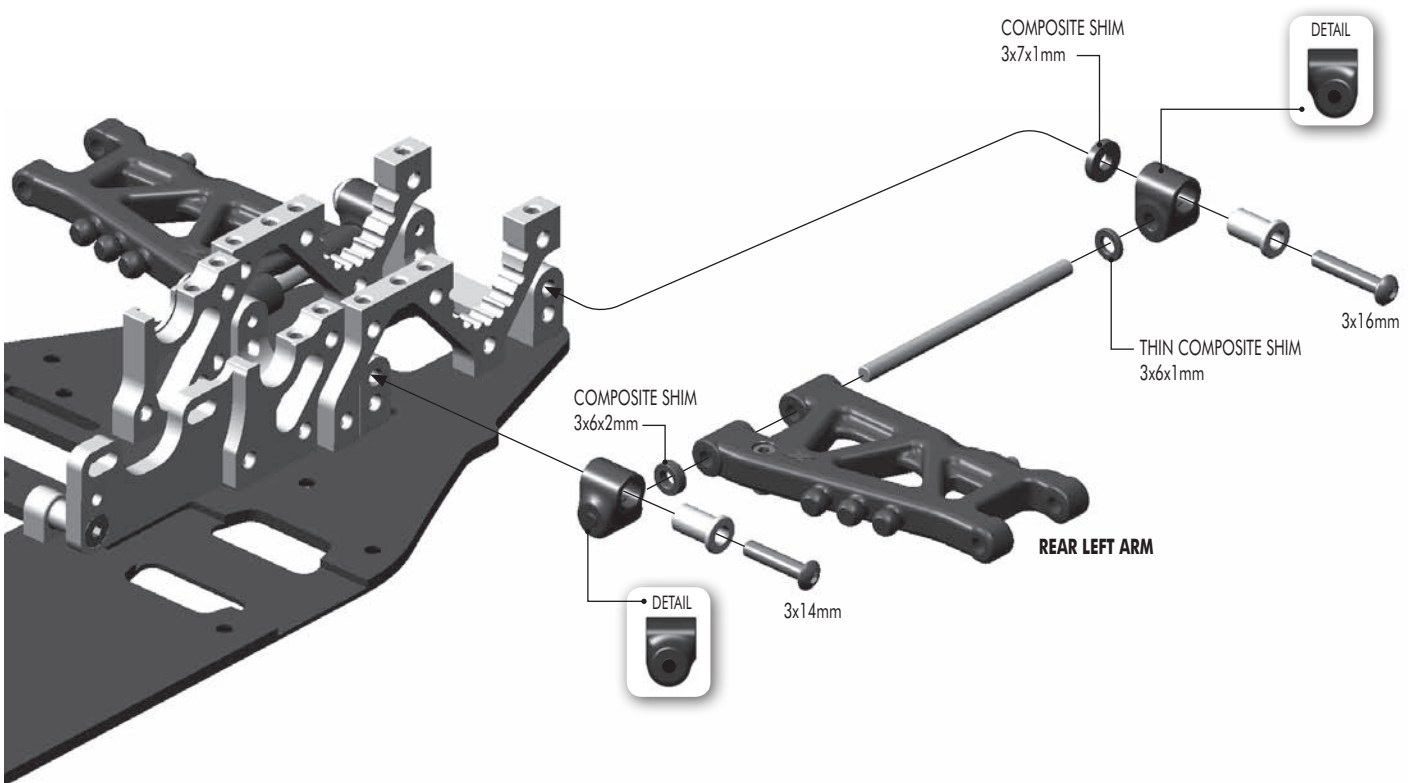
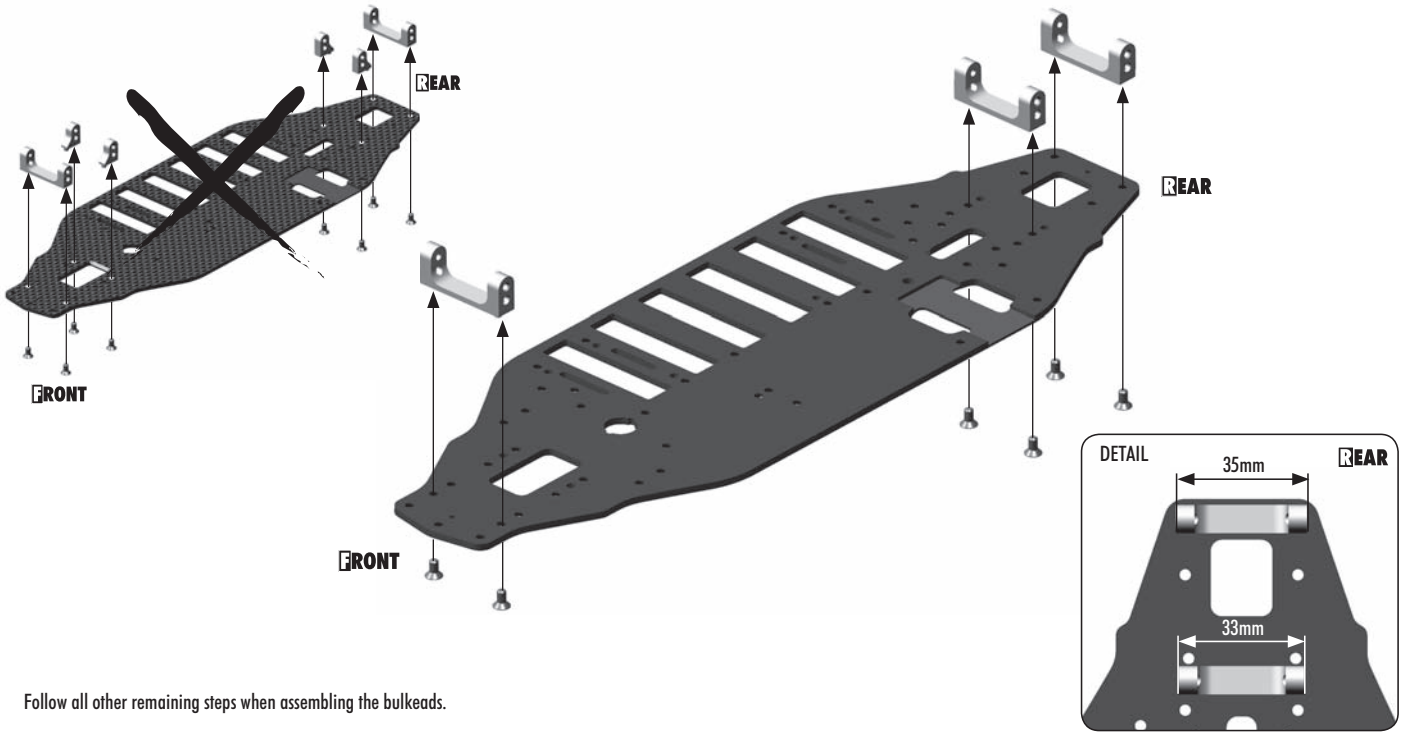

Do not follow the T3 instruction manual, it is not possible to assemble the front arms. This step will continue after assembly of 3. CENTRAL TRANSMISSION as last steps. Please continue assembly with 3. CENTRAL TRANSMISSION and then follow again the additional steps from this supplementary sheet.

3. CENTRAL TRANSMISSION

PAGE 13/ADDITIONAL STEPS

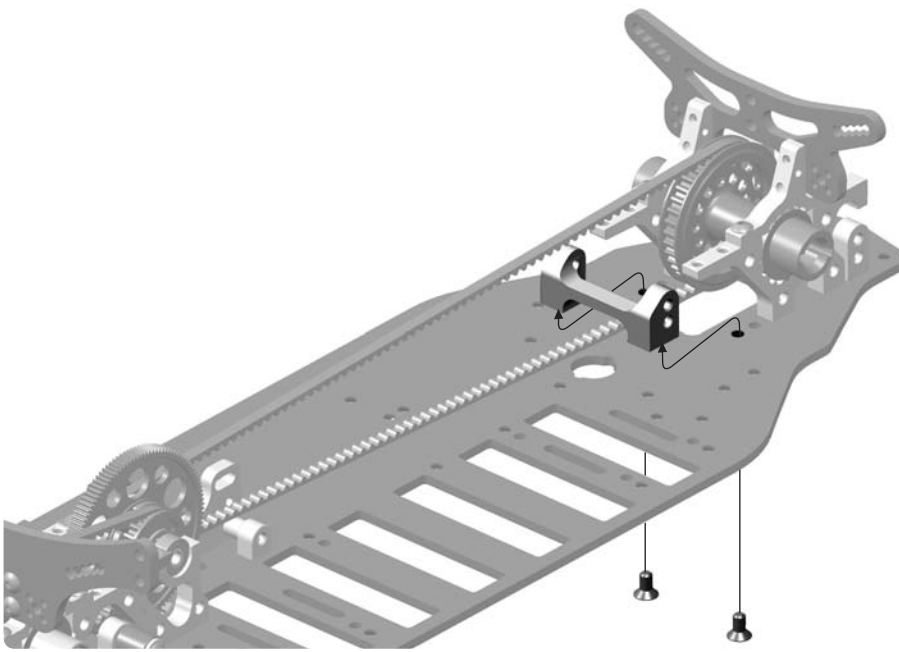

The 1-piece holder can be mounted only after long belt assembly.

3. CENTRAL TRANSMISSION

PAGE 13/ADDITIONAL STEPS

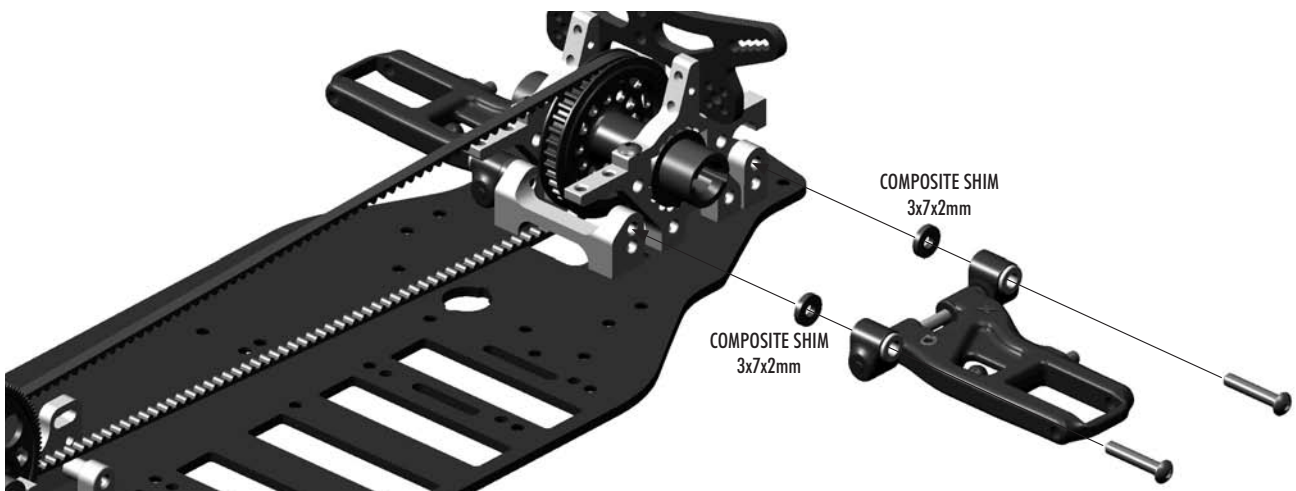

4. STEERING

PAGE 14 / STEP 2



901320
SB M3x20

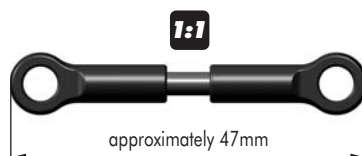

SERVO LINK
Adjust servo link to fit your servo

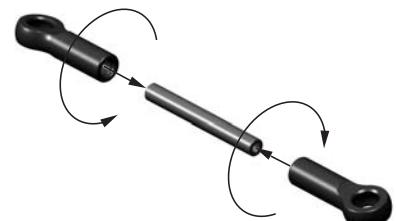

4. STEERING



307455
PB 5mm



902310
SH M3x10

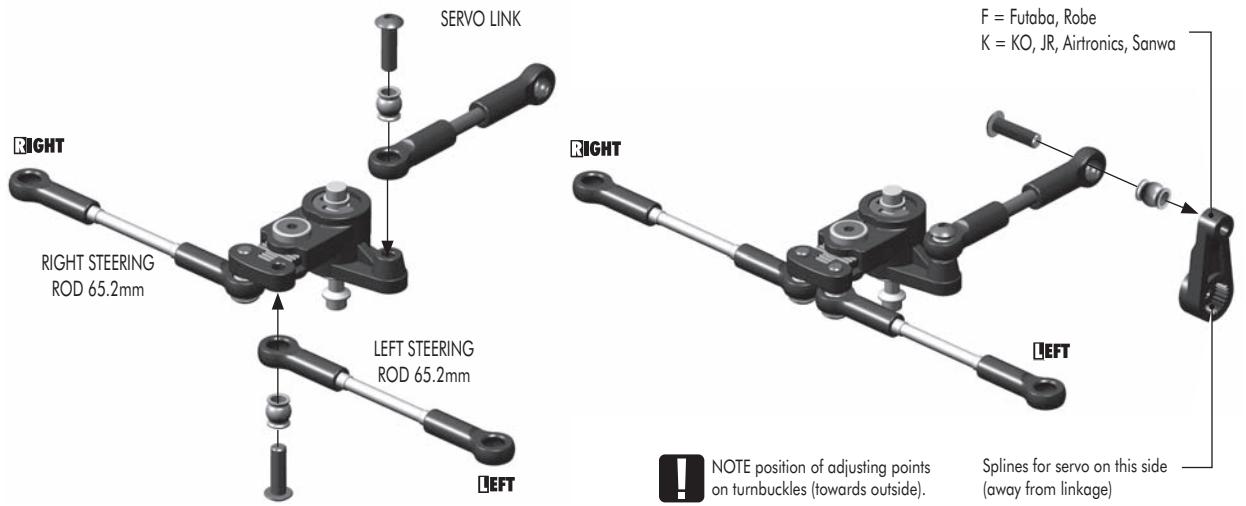

4. STEERING

BASIC SET-UP FOR EU RUBBER-SPEC

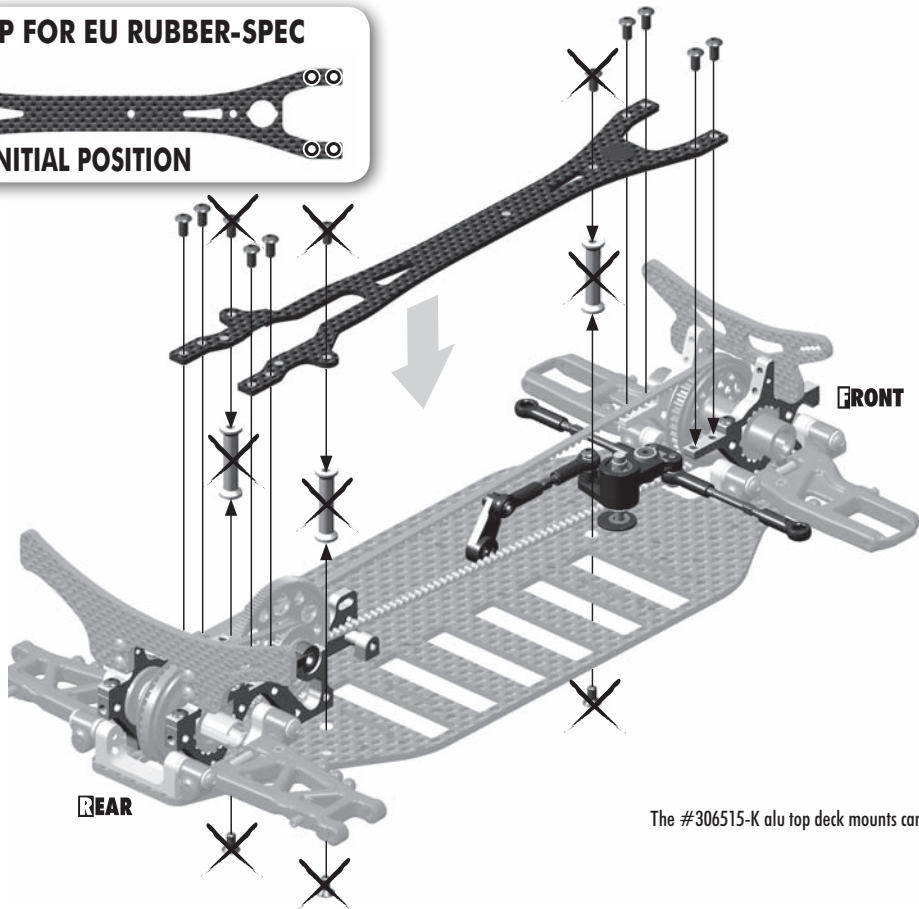

The #306515-K alu top deck mounts can be used optionally.

5. FRONT & REAR TRANSMISSION

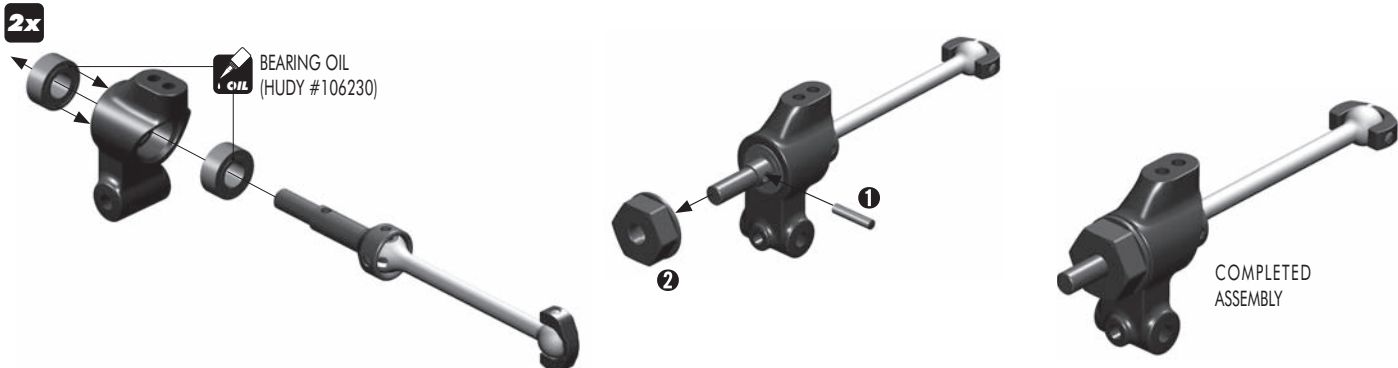

2x

OIL BEARING OIL (HUDY #106230)

L=R LEFT STEERING BLOCK = RIGHT STEERING BLOCK

L=R COMPLETED ASSEMBLY

2

1



901325
SB M3x25

4x SPECIAL UNIDIRECTIONAL BALL-JOINT WITH MOLDED DOT

L=R FRONT RIGHT = FRONT LEFT

REAR RIGHT = REAR LEFT **L=R**

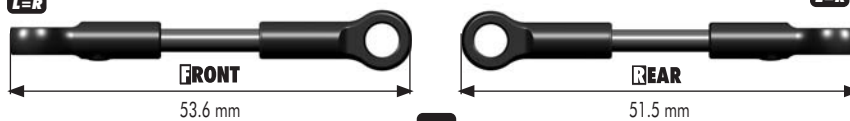

FACTORY PREASSEMBLED

MOLDED DOT

4x

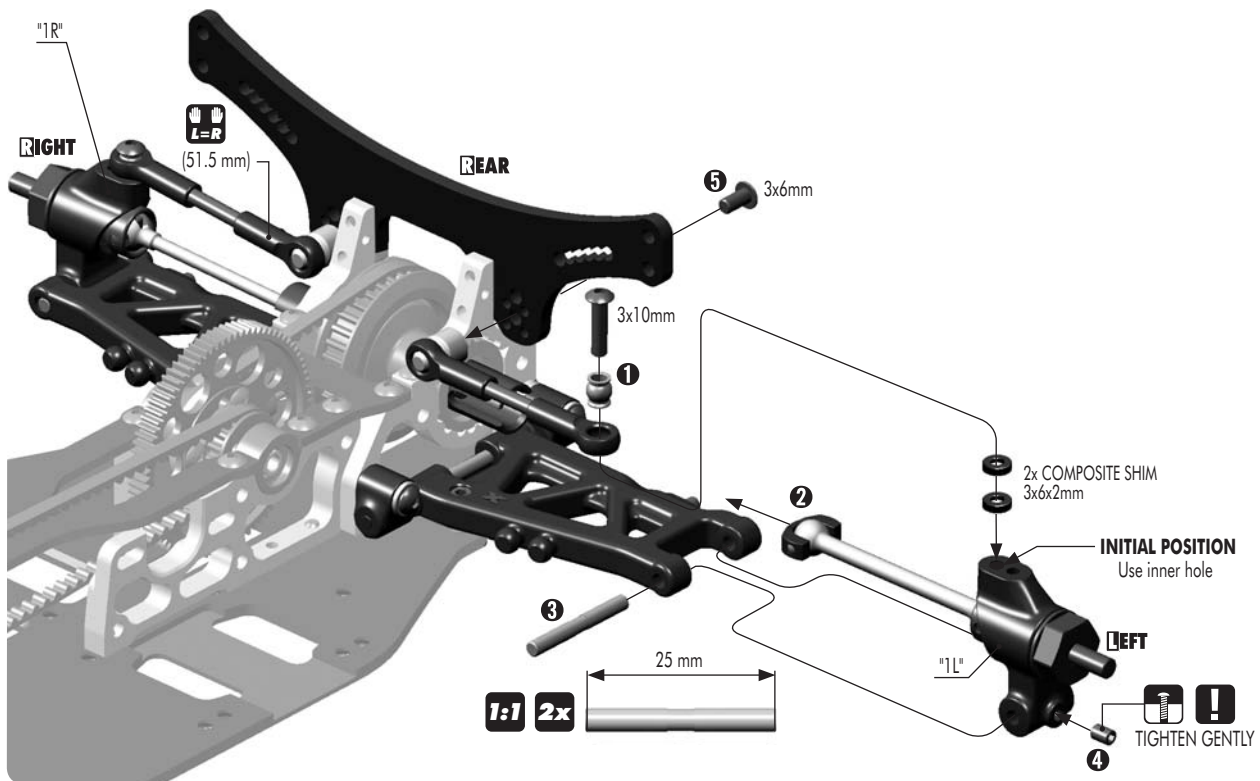

**FRONT & REAR ANTI-ROLL BARS
NOT INCLUDED**

